

Drill Press Table with an Adjustable Fence and Stop Block

TURN YOUR CONVENTIONAL DRILL PRESS INTO A MULTI-FUNCTION TOOL !

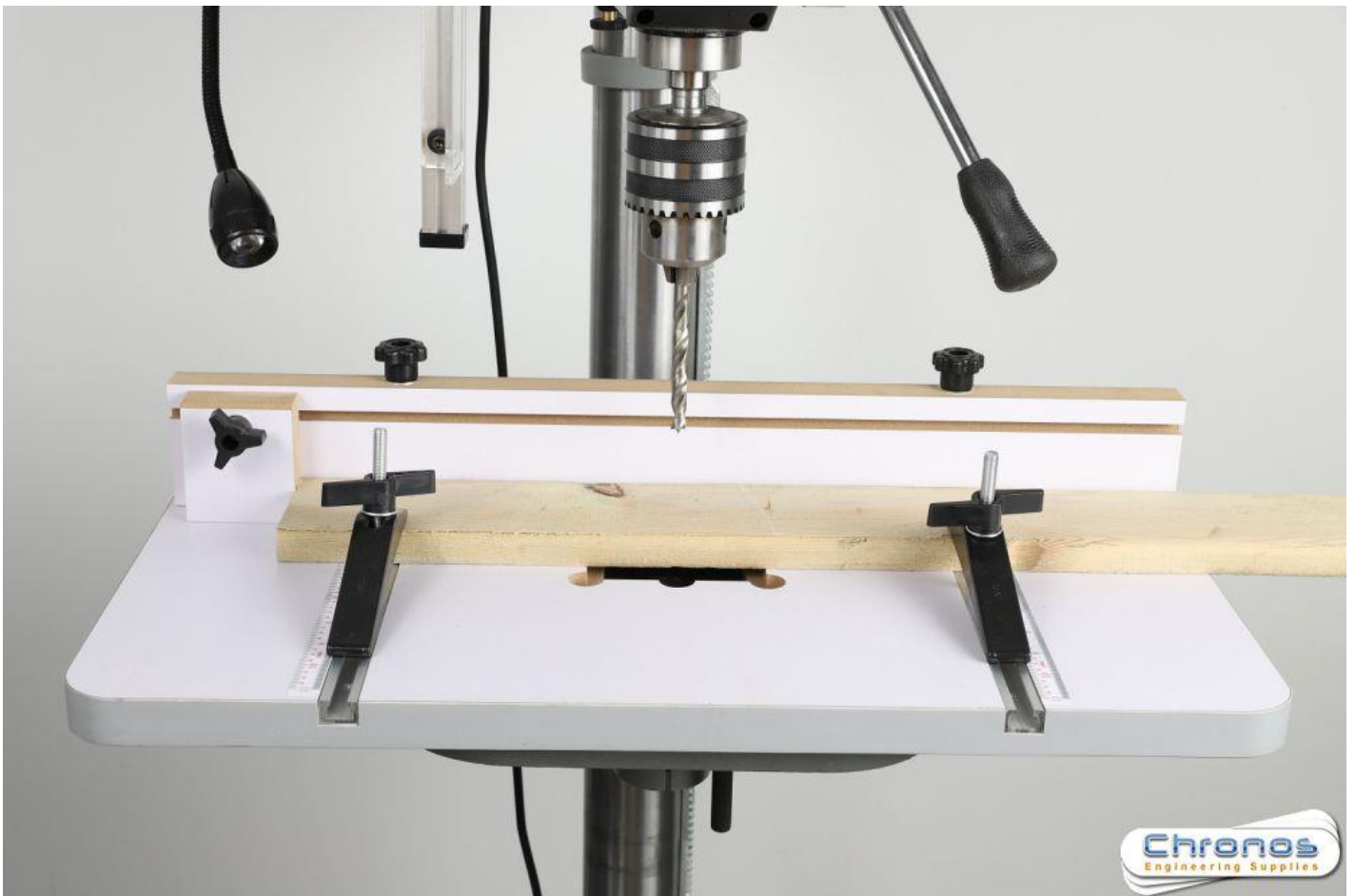

TECHNICAL DATA

	Drill Press Table Thickness	T-Track Center to Center Distance	Table and Fence Dimensions
50-242-001	7/8" (22mm)	13 in.	23-7/8 in. x 11-7/8 in. x 4 in

PART LIST

Carefully unpack all items from the box. Check all parts and compare against the exploded view and parts list below. Do not discard the packaging until the tool is completely assembled. If any part is damaged or missing, please contact us.

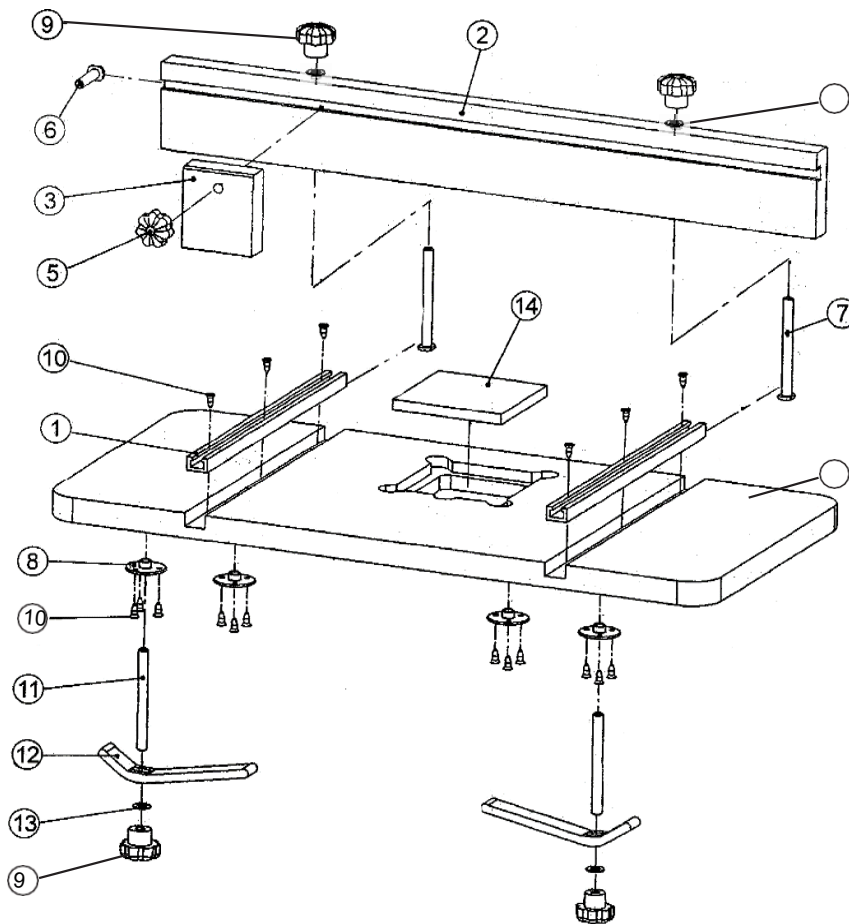

No.	Description	Qty.
1	Aluminum T-track	2
2	Fence	1
3	Fence Stop Block	1
4	Drill Press Table	1
5	Stop Block Knob M6x1	1
6	Stop Block Bolt M6x1x40	1
7	T-Slot Bolt M8x1.25x90	2

No.	Description	Qty.
8	Clamp Positioning Flange	4
9	Lock Knob	4
10	Tapping Screw M8.5x12	18
11	Full Thread Rod	2
12	Mounting Clamp	2
13	Flat Washer 8mm	5
14	Insert Block	1

INSTALLATION

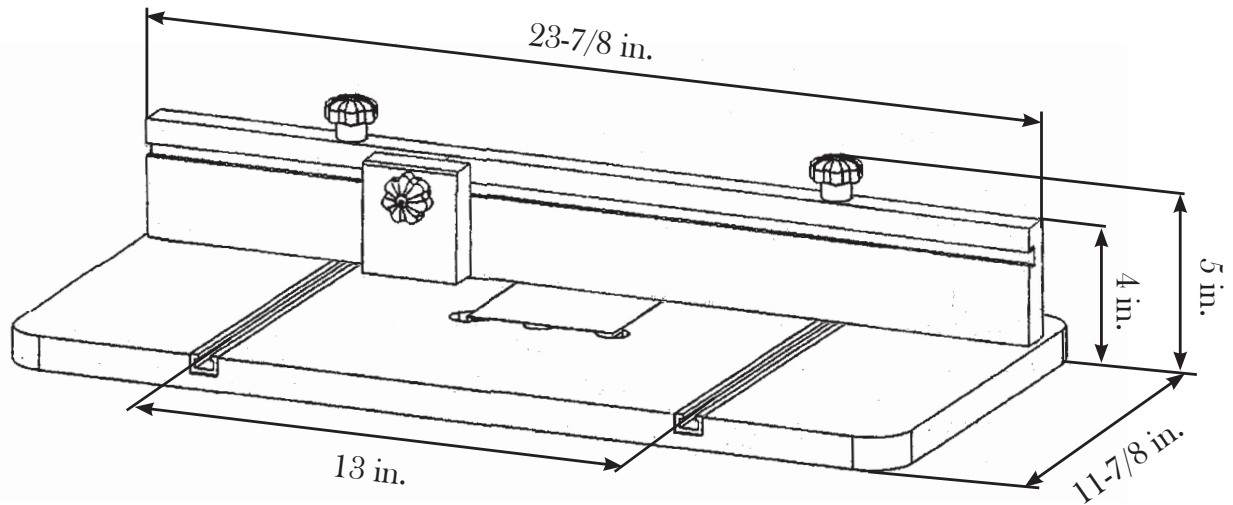

1. Unpack and assemble the drill press table according to the Parts List on above page . Refer to the dimensions listed above to determine the space and arrangements needed for your drill press table.

2. There are four clamp positioning flanges on the bottom of the drill press table (Ph. 1). Adjust the position of the clamp assemblies to fit the size of your drill press' table.

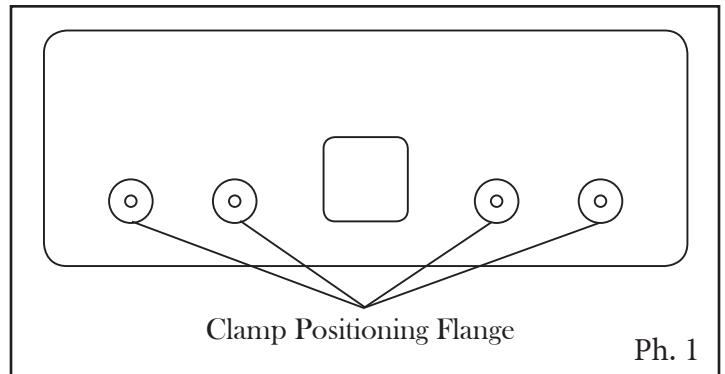

The clamps can be used in two directions, depending on the size of the table (Ph. 2). Direction A secures the table with the short side of the clamps. Direction B secures the the table with the long side of the clamps. To provide maximum stability, choose the direction that ensures the clamps tighten securely on the edge of the table.

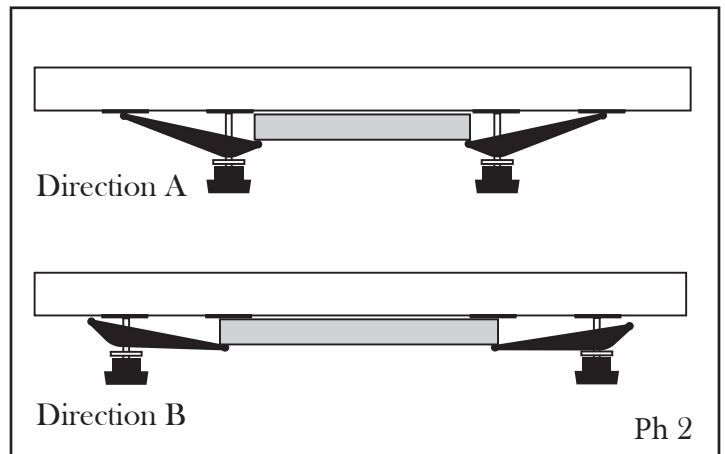

3. Tighten the clamp lock knobs to secure the drill press table in place. Check that the drill press table will not shift or wobble.

4. Turn the feed handles on the drill press (Ph. 3 - 1) to check if the stop fence will interfere with the handles.

TIP: One or two of the feed handles may be removed if the stop fence is in the way of the feed handle's travel.

5. Regularly check that the mounting clamps are secure. After each operation, wipe the drill press table clean and vacuum out the T-slots to keep the tool in good condition. To avoid condensation and rust between the two tables, do not leave the drill press table mounted on the drill press for long periods of time.

